

# **SPECIFICATION SHEET**

## **FIBERGLASS LADDERS**

## QUICK GUIDE THROUGH

LADDER TYPE	SERIES	PAGE NO.
FIBERGLASS SELF-SUPPORTED LADDER	ASL 1000 – 300 LBS TYPE IA ASL 2000 – 250 LBS TYPE I	5
FIBERGLASS SELF-SUPPORTED TWO WAY LADDER	AST 1000 – 300 LBS TYPE IA AST 2000 – 250 LBS TYPE I	6
FIBERGLASS WALL SUPPORTED LADDER	AW 1000 – 300 LBS TYPE IA	7
FIBERGLASS SELF SUPPORTED PLATFORM LADDER	ASP 1000 – 300LBS TYPE IA	8
FIBERGLASS STEP STAND LADDER	AY 8000 – 300 LBS TYPE IA	9
FIBERGLASS EXTENSION/TELESCOPIC LADDER	AE 2600 – 300 LBS TYPE IA	10
FIBERGLASS MOBILE PLATFORM LADDER	APM 1000 – 300 LBS APM 1100 – 600 LBS	11
FIBERGLASS MAINTENANCE PLATFORM LADDER	APM 3000 – 600 LBS	12
FIBERGLASS MANHOLE LADDER	AM 8400 – 300 LBS TYPE IA	12
FIBERGLASS MOBILE TELESCOPIC PLATFORM LADD.	300 LBS	13
FIBERGLASS MOBILE TELESCOPIC TILTING LADDER	300 LBS	13
FIBERGLASS SAFETY CAGED LADDER	300 LBS	14
FRP CUSTOM LADDERS & STRUCTURE	--	15

## PRODUCT FEATURES



**Shock-Free**



**Antiskid Grip**



**Economical in Long run**



**100% Rush & Water Proof**

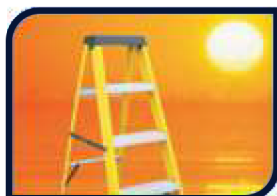

**UV Stability**



**Light weight yet strong**



**Designed for optimum stability as per international OSHA & ANSI Standards (American & European Standards)**

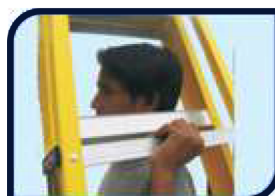

**Compact & easy to carry**



**Safe & Durable**



**Tools Tray**



**High Strength**



**Flame Retardant**

All our ladders are designed and made to meet the applicable standards & requirements of the National (IS) as well as International standards like American National Standards Institute (ANSI), OSHA etc. OSHA has set minimum requirement with respect to the use of ladders in business and industry. All ladders must be constructed in compliance with applicable safety codes of the American National Standards Institute (ANSI). Variety of ANSI safety codes is available depending on material and type of ladders. The applicable ANSI codes are as follows.

WOOD LADDER	ANSI A14.1
METAL LADDER	ANSI A14.2
FIXED LADDER	ANSI A14.3
FIBERGLASS LADDER	ANSI A14.5
STEEL LADDER	ANSI A14.7
STAGE PLATFORM	ANSI A10.8
ROLLING SCAFFOLD	ANSI A10.8



In addition, ANSI codes have established a Duty Rating which identifies the use for which a portable ladder is intended and the conditions under which the ladder can be used safely. The following table describes the various types of ladders.

TYPE	CAPABLE OF SUPPORTING	RATED USE
TYPE IAA	375Lbs.	EXTRA HEAVY DUTY INDUSTRIAL
TYPE IA	300Lbs.	EXTRA HEAVY DUTY INDUSTRIAL
TYPE I	250Lbs.	HEAVY DUTY INDUSTRIAL
TYPE II	225Lbs.	MEDIUM DUTY COMMERCIAL
TYPE III	200Lbs.	LIGHT DUTY HOUSE HOLD

An extensive series of tests and design requirements determines which Duty Rating a particular ladder may be labeled with. The total load supported includes the combined weight of the user, clothing, tools and any material on the ladder. The tests' requirements have been specified with a safety factor of four to ensure the ability to meet the Duty Rating. However, ladders must be used properly in order to support the intended load.

#### Inspection before each use of ladder:

Inspect the ladder thoroughly for missing or damaged components before using a ladder. Never use a damaged ladder & also never make temporary repairs. Inspect thoroughly for loose fasteners. Make sure all working & moving parts are in good working condition, if required lubricate the same. Clean ladder from all foreign materials like water, mud, grease, oil etc.

#### Consider before use of ladder:

- Metal Ladder conducts Electricity hence keep away from electrical circuits. Use FRP ladders instead of metal ladders as metal ladders conduct electricity.
- We request you to use ladder as per the instruction, do not overload it. It is designed for one person only. Do not use in poor health, or alcoholic conditions or physically handicapped condition.
- Keep shoes clean & do not use leather shoes while using ladder.
- Never leave ladder set up & unattended.



## FIBERGLASS SELF-SUPPORTED LADDER

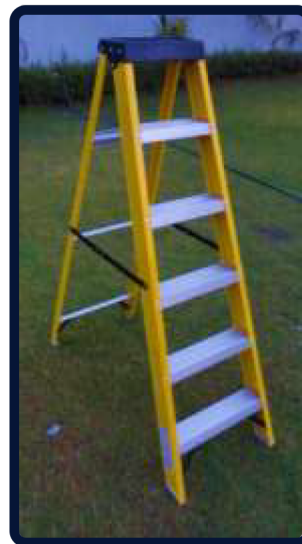

- Extra heavy duty step ladder for all industrial applications.
- Moulded top with Recess tray: Nonconductive Structural moulded top, with slots help to keep tools close at hand.
- Inside Spreader Braces
- Aluminium Feet with Slip Resistant thick rubber tread.
- Full Channel Fiberglass
- Heavy Gusset Bracing: Two pairs of gusset support at the bottom step. All gussets are heavy duty steel.

### **TYPE IA – 300 LBS EXTRA HEAVY DUTY INDUSTRIAL**

Model	Size	Step Size	Width	Approx. Spread	Approx. Wt.	Approx. Cube
ASL 1003	3FT	3"	17.5"	23"	6	3.23'
ASL 1004	4FT	3"	19"	29"	8	4.05'
ASL 1005	5FT	3"	21.5"	35"	9.5	5.17'
ASL 1006	6FT	3"	23"	41"	11	6.2'
ASL 1007	7FT	3"	24.5"	48"	13	7.86'
ASL 1008	8FT	3"	26"	54"	15	9.5'
ASL 1010	10FT	3"	29"	66"	19	12.54'
ASL 1012	12FT	3"	32"	78"	24	16.10'

### **TYPE I – 250 LBS EXTRA HEAVY DUTY INDUSTRIAL**

Model	Size	Step Size	Width	Approx. Spread	Approx. Wt.	Approx. Cube
ASL 2004	4FT	3"	19"	29"	5	4.05'
ASL 2005	5FT	3"	21.5"	35"	6.5	5.17'
ASL 2006	6FT	3"	23"	41"	7.5	6.2'
ASL 2008	8FT	3"	24.5"	48"	15	9.5'

## **FIBERGLASS SELF-SUPPORTED TWO WAY LADDER**

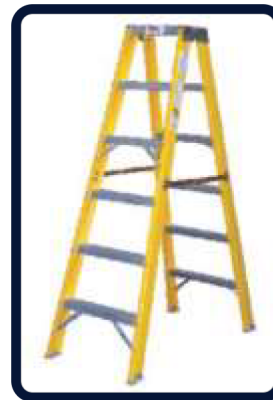

Two side mechanical step ladder is designed as trestle ladder for entry from either side. Nonconductive fiberglass rail with fully serrated aluminium steps on front & back.

- Heavy Gauge Steel Hinges: Suitable for industrial application.
- Heavy Gusset Bracing: Two pairs of gusset support at the bottom step. All gussets are heavy duty steel.
- Pinch proof Spreader Braces: Heavy duty plated steel spreader braces with double rivet hinge - these protect the user from pinched fingers.
- Full Channel of Fiberglass: Nonconductive full channel rails with polyester veil.
- Slip Resistant Rubber Feet: Aluminum feet with thick rubber tread.
- Inside Spreader Braces

### **TYPE IA – 300 LBS EXTRA HEAVY DUTY INDUSTRIAL**

Model	Size	Step Width	Bottom Width	Approx. Spread	Approx. Wt.	Approx. Cube
AST 1004	4FT	3"	19"	36"	10.5	4.05'
AST 1005	5FT	3"	21.5"	45"	12	5.01'
AST 1006	6FT	3"	23"	52"	13	6.53'
AST 1007	8FT	3"	24.5"	60"	17	8.10'
AST 1008	8 FT	3"	26"	67"	20	9.51'
AST 1010	10 FT	3"	29"	83"	27	13.44'
AST 1012	12 FT	3"	32"	98"	33	17.25'
AST 1014	14 FT	3"	35"	112"	38	22.50'
AST 1016	16 FT	3"	38"	127"	45	27.50'
AST 1018	18FT	3"	41"	142"	51	33.00'

### **TYPE I – 250 LBS EXTRA HEAVY DUTY INDUSTRIAL**

Model	Size	Step Width	Bottom Width	Approx. Spread	Approx. Wt.	Approx. Cube
AST 2004	4FT	3"	19"	36"	10.5	4.05'
AST 2005	5FT	3"	21.5"	45"	12	5.01'
AST 2006	6FT	3"	23"	52"	13	6.53'
AST 2007	7 FT	3"	24.5"	60"	17	8.10'
AST 2008	8 FT	3"	26"	67"	20	9.51'
AST 2010	10 FT	3"	29"	83"	27	13.44'
AST 2012	12 FT	3"	32"	98"	33	17.25'

## FIBERGLASS WALL SUPPORTED LADDER

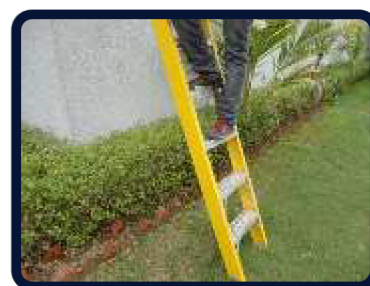
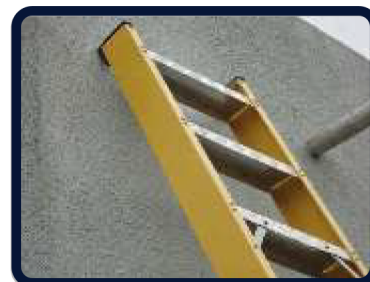

Extra heavy duty 300lbs rated, shelf ladder for all industrial application. Steps are level when the ladder is set at 18 Degree. Nonconductive fiberglass side rail with fully serrated aluminium step.

- Rubber Bumper: Thick rubber of 6" length parallel to sides of ladder.
- Heavy Gusset Bracing : Two pairs of gusset support at the bottom step. All gussets are heavy duty steel.
- Slip Resistant Rubber Feet: Aluminum feet with thick rubber tread.

### TYPE IA – 300 LBS EXTRA HEAVY DUTY INDUSTRIAL

Model	Total Length	Step Size	Width	Approx. Wt.	Approx. Cube.
AW 1004	4FT	3"	15"	4.0	1.25'
AW 1005	5FT	3"	15"	5.0	1.56'
AW 1006	6FT	3"	15"	6.0	1.87'
AW 1007	7 FT	3"	15"	8.0	2.18'
AW 1008	8 FT	3"	15"	8.5	2.50'
AW 1010	10 FT	3"	15"	10.5	3.12'
AW 1012	12 FT	3"	15"	12.5	4.95'
AW 1014	14FT	3"	17"	15.5	6.54'
AW 1016	16FT	3"	17"	18	7.50'
AW 1018	18FT	3"	17"	20	8.43'
AW 1020	20FT	3"	17"	22	9.37'

## **FIBERGLASS SELF SUPPORTED PLATFORM LADDER**



Fiberglass platform ladder designed for prolong standing at one height. Nonconductive fiberglass rail with fully serrated aluminium step & platform.

- Slip Resistant Platform: Large fully serrated platform 15" wide 20" deep, it locks ladder.
- Heavy Gusset Bracing: Two pairs of gusset support at the bottom step. All gussets are heavy duty steel.
- Slip Resistant Rubber Feet: Aluminium feet with thick rubber tread.
- Top Rail Guard: To serve as a railing for working from platform.
- Option of castor, handrails, foldable platform.

### **TYPE IA – 300 LBS EXTRA HEAVY DUTY INDUSTRIAL**

Model	Size	Step Width	Approx Spread	Width	Approx. Wt.	Approx. Cube
ASP 1003	3FT	3"	30"	22"	10	3.65'
ASP 1004	4 FT	3"	38"	23.5"	12	5.06'
ASP 1005	5 FT	3"	43"	25"	14	6.56'
ASP 1006	6 FT	3"	50"	26.5"	16	8.15'
ASP 1008	8 FT	3"	62"	29.5"	22	11.62'
ASP 1010	10 FT	3"	75"	32"	29	15.31'
ASP 1012	12 FT	3"	88"	35"	34	19.50'

## FIBERGLASS STEP STAND LADDER



These multipurpose, heavy duty industrial domestic step stands are available as light weight, non-conductive fiberglass step stand.

- Large Moulded Top: Nonconductive moulded top. 14" wide & 10" deep.
- Heavy Gusset Bracing: Two pairs of gusset support at the bottom step. All gussets are heavy duty steel.
- Slip Resistant Rubber Feet: Aluminium feet with thick rubber tread.

Model	Size	Top width	Approx. Spread	Width	Approx. Wt.	Approx. Cube
AY 8001	1FT	14X10"	15"	15"	4	1.56'
AY 8002	2FT	14X10"	21"	18"	8	5.25'
AY 8003	3FT	14X10"	27"	20"	11	11.25'
AY 8004	4FT	14X10"	33"	22"	14	20.16'

## FIBERGLASS EXTENSION/TELESCOPIC LADDER

Heavy Duty channel extension ladder for all industrial application, Full channel nonconductive side rails. Set ladder at the proper working angle.

- Round Fully Serrated Tempered Rungs.  
Rungs are connected with Plates.
- Easy one handed locking system.
- Swivel Safety Shoes Aluminum Shoe with thick rubber treads.
- Full Channel Fiberglass Channel Nonconductive.



SIZE	RAIL DEPTH	TOTAL HT.	APPROX INSIDE WIDTH		APPROX OUTSIDE WIDTH	
			BASE	FLY	BASE	FLY
16-40'	4"	6.5"	15"	14"	18"	16.5"

MODEL	TOTAL LENGTH	LENGTH OF SECTION	EXTEN. HEIGHT	APPROX. WT.	APPROX. CUBE.
AE 2616	16'	8'	13'	21	7.8'
AE 2620	20'	10'	17'	23	9.54'
AE 2624	24'	12'	21'	28	11.34'
AE 2628	28'	14'	25'	32	13.23'
AE 2632	32'	16'	29'	36	15.12'
AE 2636	36'	18'	32'	40	17.01'
AE 2640	40'	20'	35'	45	18.90'



## FIBERGLASS MOBILE PLATFORM LADDER



This mobile maintenance platform is specially designed for working around electricity, its non-conductive material & heavy duty construction provides safety on jobs where electrical lines are present.

- Heavy Duty anti skid step assembly.
- Non conductive Platform Assembly.
- Heavy Duty Base Assembly.
- Non Conductive Handrail & Guard Rail
- SafetyLock Feature with Handle for Wheel Engagement.
- Safety Yellow Color.

### **APM1000 SERIES SINGLE PERSON 24L X 17W 300LBS CAPACITY**

Model	Size	HT to Step	Max Length	Max Width	Max HT with Side	WT in Kg.	Approx Cube
APM 1005	5	4'	63"	32"	7'.6"	79	18'
APM 1006	6	4'.9"	71"	32"	8'.3"	86	21'
APM 1007	7	5'.7"	80"	32"	9'.1"	106	25'
APM 1008	8	6'.4"	89"	32"	9'.10"	117	28'
APM 1009	9	7'.2"	97"	32"	10'.8"	127	31'
APM 1010	10	7'.11"	106"	32"	11'.5"	184	60'
APM 1011	11	8'.9"	114"	36"	12'.3"	193	66'
APM 1012	12	9'.6"	123"	36"	13'	200	71'
APM 1013	13	10'.4"	131"	39"	13'.10"	233	77'
APM 1014	14	11'.1.5"	140"	39"	14'.10"	241	83'
APM 1015	15	11'.11"	148"	39"	15'.5"	248	89'

### **APM 1100 SERIES DOUBLE PERSON 24L X 34W 600LBS CAPACITY**

Model	Size	HT to Step	Max Length	Max Width	Max HT with Side	WT in Kg.	Approx Cube
APM 1105	5	4'	80"	32"	7'.6"	88	25'
APM 1106	6	4'.9"	92"	32"	8'.3"	95	28'
APM 1107	7	5'.7"	97"	32"	9'.1"	115	31'
APM 1108	8	6'.4"	106"	32"	9'.10"	126	60'
APM 1109	9	7'.2"	114"	32"	10'.8"	136	66'
APM 1110	10	7'.11"	123"	32"	11'.5"	197	71'
APM 1111	11	8'.9"	131"	36"	12'.3"	207	77'
APM 1112	12	9'.6"	140"	36"	13'	214	83'
APM 1113	13	10'.4"	148"	39"	13'.10"	246	89'
APM 1114	14	11'.1.5"	157"	39"	14'.10"	255	95'
APM 1115	15	11'.11"	166"	39"	15'.5"	261	101'

## FIBERGLASS MAINTENANCE PLATFORM LADDER



This mobile maintenance platform is specially designed for working around electricity, its non conductive material & heavy duty construction provides safety jobs where electrical lines are present. This ladder has a platform of size 600mm(W) X 800mm(L), which gives comfort to the user. The ladder has spring loaded castors, to move ladder easily.

### APM 3000 SERIES

Capacity	600 LBS
Duty Rating	Type IA
Sizes	3FT to 6FT Height.

## FIBERGLASS MANHOLE LADDER

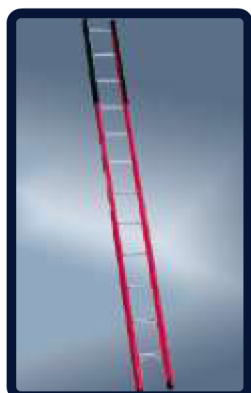

A narrow fiberglass Straight ladder design for use in manholes. Full Channel nonconductive side rails. Width of all sizes is 14".

- Round Fully Serrated Tempered Rungs.
- Optional Rail Protector can be ordered with durable rail guards to protect the side rail from metallic rim of manhole.
- Safety Shoes Aluminium Shoe with thick rubber treads.
- Full Channel Fiberglass Channel Nonconductive.

Size	Rail Depth	Approx Inside width	Approx Outside width
8-20'	3-1/4"	11.5/8"	14"

Model	Total Length	Approx. Wt.	Approx. Cube.
AM 8408	8'	9	2.5'
AM 8410	10'	11	3.48'
AM 8412	12'	13	4.2'
AM 8414	14'	16	5.0'
AM 8416	16'	17	5.6'
AM 8418	18'	20	6.5'
AM 8420	20'	21	7.0'



## FIBERGLASS MOBILE TELESCOPIC PLATFORM LADDER

This ladder is designed for working on street light application.

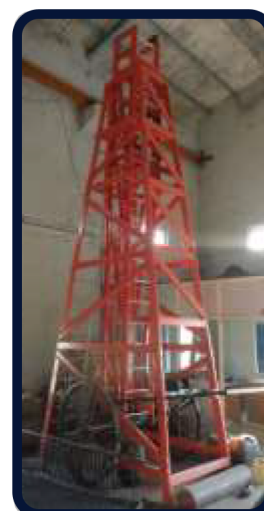

Capacity	300 LBS
Duty Rating	Type IA
Sizes	15FT to 30FT Platform Height.

## FIBERGLASS MOBILE TELESCOPIC TILTING LADDER

This ladder is designed for working on street light application.



Capacity	300 LBS
Duty Rating	Type IA
Sizes	15FT to 30FT Platform Height.

## FIBERGLASS SAFETY CAGED LADDER

SDI FRP Ladders and Safety Cages are fabricated from fiberglass pultrusions that have a Class 1 fire retardance, with an ASTM E-84 flame spread rating of 25 or less.

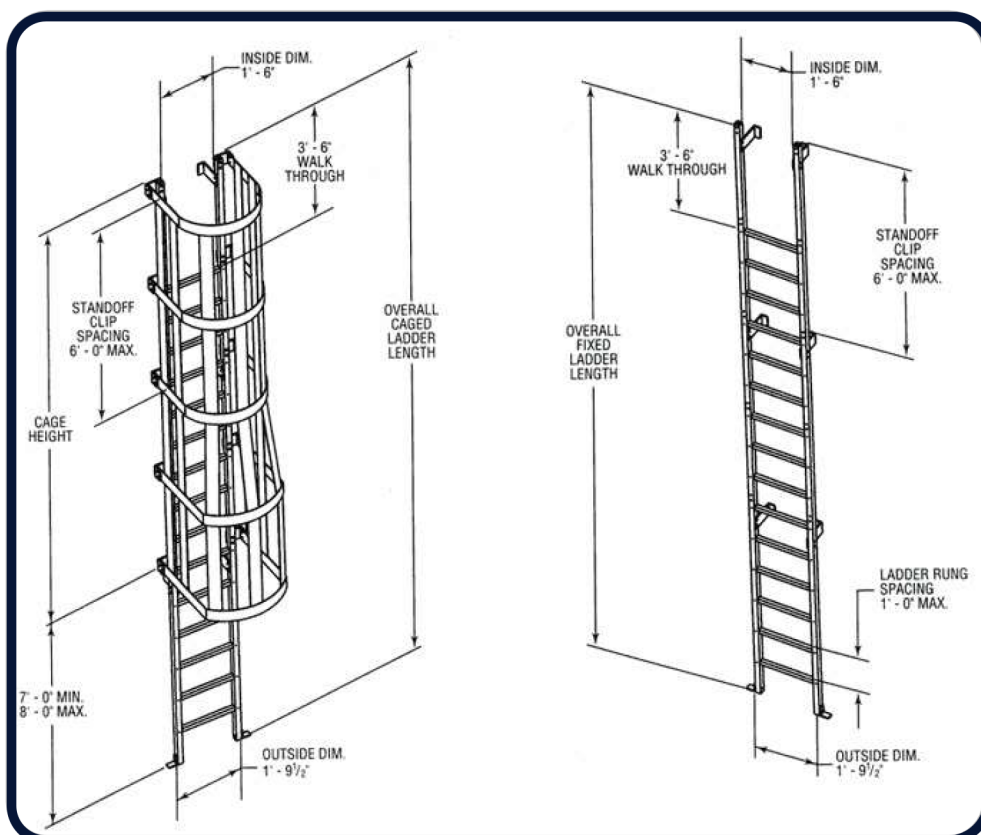

## FRP CUSTOM LADDERS & STRUCTURE

A design & build service utilising CAD Technology is available for the construction of bespoke Platforms, Stair-Cases & Hand railing, all manufactured from FRP Structural Profiles.

Composite Installations are ideal for corrosive & marine environments, and provide exceptional thermal and dimensional stability, are electromagnetically transparent, non-conductive, and require minimal periodic maintenance.





**SRK**  
A **SRK** Product  
THE COMPOSITE EXPERT.

**CORROSION FREE  
COMPOSITE SOLUTIONS**



FRP Cable Tray



FRP Ladder



FRP Poles & Mast



FRP Structural Profiles



FRP Storage Tanks



FRP Handrails



Trefoil Clamp



FRP Canopy



FRP Gratings

**REGISTERED OFFICE / WORKS:**

A : Chhattisgarh (India)  
Delhi (NCR)

T : +91 9893172716 / T : +91 6232862816

E : [info@shridhaniramimpex.com](mailto:info@shridhaniramimpex.com)

W : [www.shridhaniramimpex.com](http://www.shridhaniramimpex.com)